

**SPC-10S2**  
**SPC-10S4**

**Speaker Mounting**

Toss those mismatched drywall screws aside like yesterday's news and get ready for some deluxe speaker mounting options that will make you feel like a fancy-pants audiophile.

**Mounting Option 1**

1. Position and secure the template in desired location.
2. Carefully mark the 8 mounting hole locations.
3. Remove the template and drill 1/8" pilot holes in each location.
4. When it's time to mount your speaker, use a 4mm Hex and the ST5 x 25mm wood screws to secure.



**Mounting Option 2**

1. Position and secure the template in desired location.
2. Carefully mark the 8 mounting hole locations.
3. Remove the template and drill 1/4" through holes in each location.
4. Using a 3/8" drill bit, counterbore each hole 1/64". This is to allow the tapping insert to sit flush with surface.

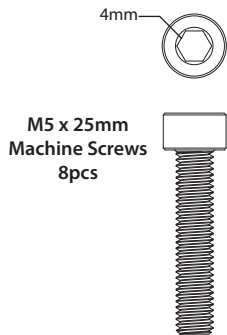
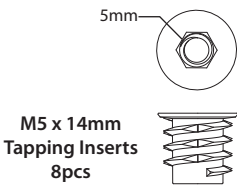
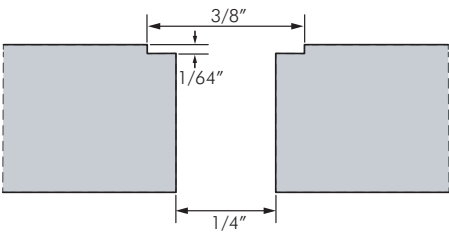

5. Using a 5mm Hex, install a tapping insert in each location.
6. When it's time to mount your speaker, use a 4mm Hex and the M5 x 25mm machine screws to secure.

