

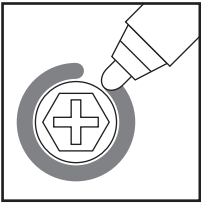

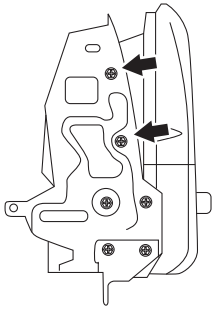

2. Install the Double DIN Head Unit.

2.1 Use a marker pen to mark the positions of the upper 2 fasteners on both sides of the brackets before unscrewing and removing. This is important to ensure correct alignment when reassembling.



**IMPORTANT!**  
Mark the position of fasteners on both sides before unscrewing.

2.2 With both brackets removed, hold the radio receiver stationary and slide the Integration Control Panel forward in the direction of the arrow as shown below to separate.

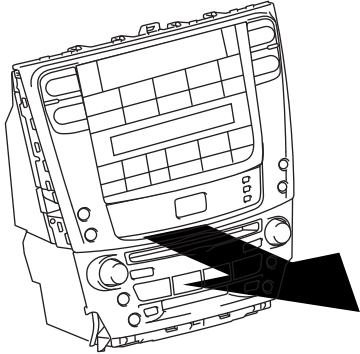

2.3 Attach the supplied mounting brackets to the 2-DIN aftermarket head unit using the screws that came supplied with the head unit. Take care to install the left (marked “140L”) and right (marked “140R”) brackets accordingly. Apply the supplied adhesive padding tape to both sides as shown below.

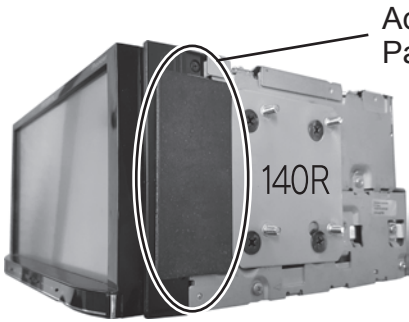

**Hint!**  
Depending on head unit, it may not be possible to attach all 4 screws.

2.4 Re-attach one of the OEM brackets to one side of the Integration Control Panel and align the fasteners with the previously marked positions. Attach the 2-DIN aftermarket head unit to the bracket and lightly secure using the fasteners. Do not fully tighten the fasteners yet as adjustment may be necessary. Repeat for the other side so that both OEM brackets are attached.

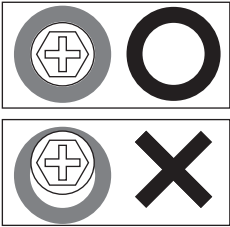
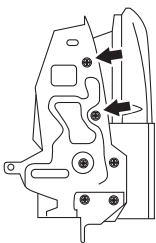

2.5 Align the 2-DIN aftermarket head unit so that it is exactly centered with respect to the Integration Control Panel. Use a ruler to measure the distance from the outside edge of the Integration Control Panel to the side of the 2-DIN aftermarket head unit. The distance on both sides must be exactly the same. Tighten the fasteners on either side then recheck to confirm alignment and adjust if necessary.



**IMPORTANT!**  
Head unit must be correctly centered

3. Re-Install the Integration Control Panel with 2-DIN Head Unit

- 3.1 Connect the SLX-140L adapter harness and all Integration Control Panel connectors. Refer to Appendix A. for connection of steering wheel audio controls.
- 3.3 Re-install the Integration Control Panel assembly taking care not to crush or kink the wiring behind. Secure using the 4 mounting fasteners.
- 3.4 Confirm operation of new head unit, steering wheel controls and Integration Control Panel functions including air-con, heater, illumination, hazard switch etc. Buttons related to the factory radio receiver will no longer work (see Appendix B).
- 3.5 Re-install the ashtray and console sub panel assembly.
- 3.6 Insert fascia garnish trim on either side of the 2-DIN aftermarket head unit and sub panel assembly. Start by locating clip 1 then clip 2 as shown below.

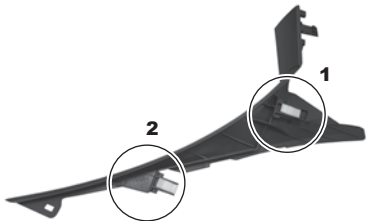
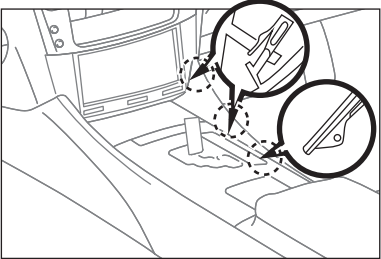

3.7 Re-install the upper vent to complete the installation.

Appendix A.

Steering Wheel Audio Controls

The SLX-140L provides the necessary wires to connect the OEM steering wheel audio control buttons to the aftermarket head unit. Depending on the head unit, a steering wheel control interface (available separately) may be required.

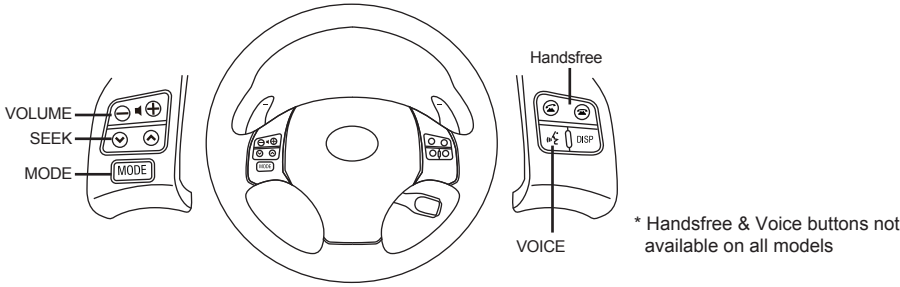

\* Handsfree & Voice buttons not available on all models



- 1. Connect SWG (Pin-6 Black) to the SWG input on the aftermarket head unit.
- 2. Connect SW1 (Pin-7 White) to the SW1 input on the aftermarket head unit.
- 3. Connect SW2 (Pin-8 Green) to the SW2 input of the aftermarket head unit.

Appendix B.

Vehicles equipped with Handsfree

Handsfree and Bluetooth is not retained after the OEM head unit has been removed. Ensure that all registered mobile phones are deleted prior to removing the OEM head unit to prevent accidental pairing to the redundant Bluetooth connection.

- 1. Select “Delete Phone” using a voice command or ,  and
- 2. Select mobile phone to be deleted using ,  and
- 3. Select “Yes” using ,  and

**Hint!**  
Handsfree connection can be made to aftermarket head unit (provided this feature is supported)

Audio Settings

Only the buttons circled below are retained after the OEM head unit has been removed. All other Integration Control Panel buttons related to the OEM radio will not function after the OEM head unit has been removed.

With the exception of fader (FAD), all audio setting adjustments are fixed to neutral and cannot be adjusted by the Integration Control Panel. Adjustment can be made via the aftermarket head unit.

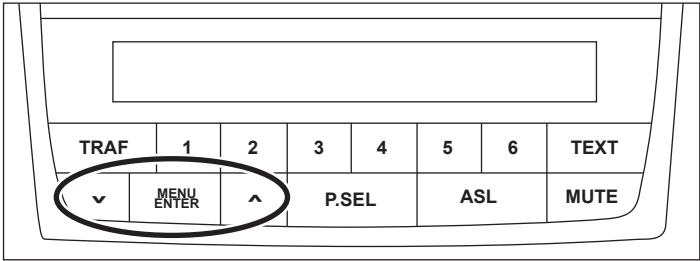

\* Buttons may vary depending on grade and model.

International enquiries.



472-5, Koushin, Fujieda, Nisshin, Aichi, JAPAN.  
TEL: +81-561-73-9000 FAX: +81-561-74-5554  
www.beatsonic.co.jp E-mail: enquiries@beatsonic.co.jp

USA and Canada enquiries.



14778 Beach Blvd. La Mirada, CA 90638  
TEL: 1-714-994-1085 FAX: 1-714-249-4741  
www.beatsonicusa.com E-mail: info@beatsonicusa.com