

"2-DIN" NAVIGATOR MOUNTING KIT - 7" MONITOR

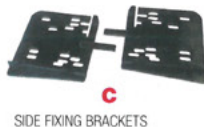

IMPORTANT TO KNOW THAT:

For navigators with depths exceeding 150 mm it is essential to remove a small interference (See Picture).

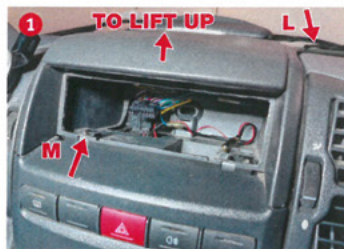

1. Remove the car radio, recover the two front screws **M** and the two rear screws **L** then remove the original panel.



2. Place the "base bracket **B**" using the two screws original **M**.

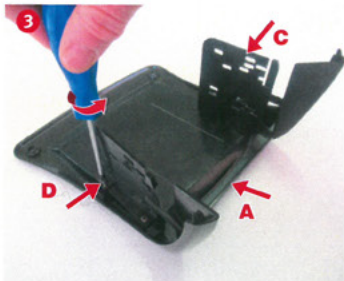

3. To install the navigator, it is necessary to place the "Navigator panel **A**" **UPSIDE DOWN** (on a suitable clean surface) and position the "side brackets **C**" (right and left) with the screws self-tapping **D** (or **D** with washers **F**) supplied without locking them.

4. Place the navigator **UPSIDE DOWN** on the two ribs **N**, push it towards the front of the panel into position desired by making it protrude at least 5 mm, then fix it on the brackets **C** with screws **E** (or **D** with washers **F**) supplied.

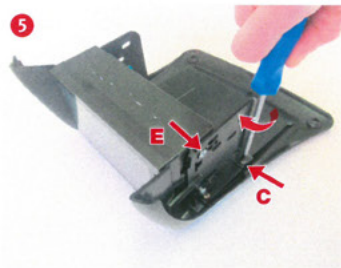
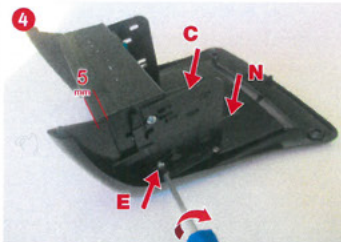

5. Finally tighten the screws **E** (at least 2 per side) and lock the brackets **C** on the fascia panel.

6. Turn the assembly (panel with navigator) and after making the necessary connections, position it from above on the vehicle by inserting the reference pins in their seats exerting a moderate pressure downwards to hook it to the "CLIPS" of the base bracket **B** previously mounted at "Point 2" and with the original screws **L** fix it to the rear of the vehicle.

