

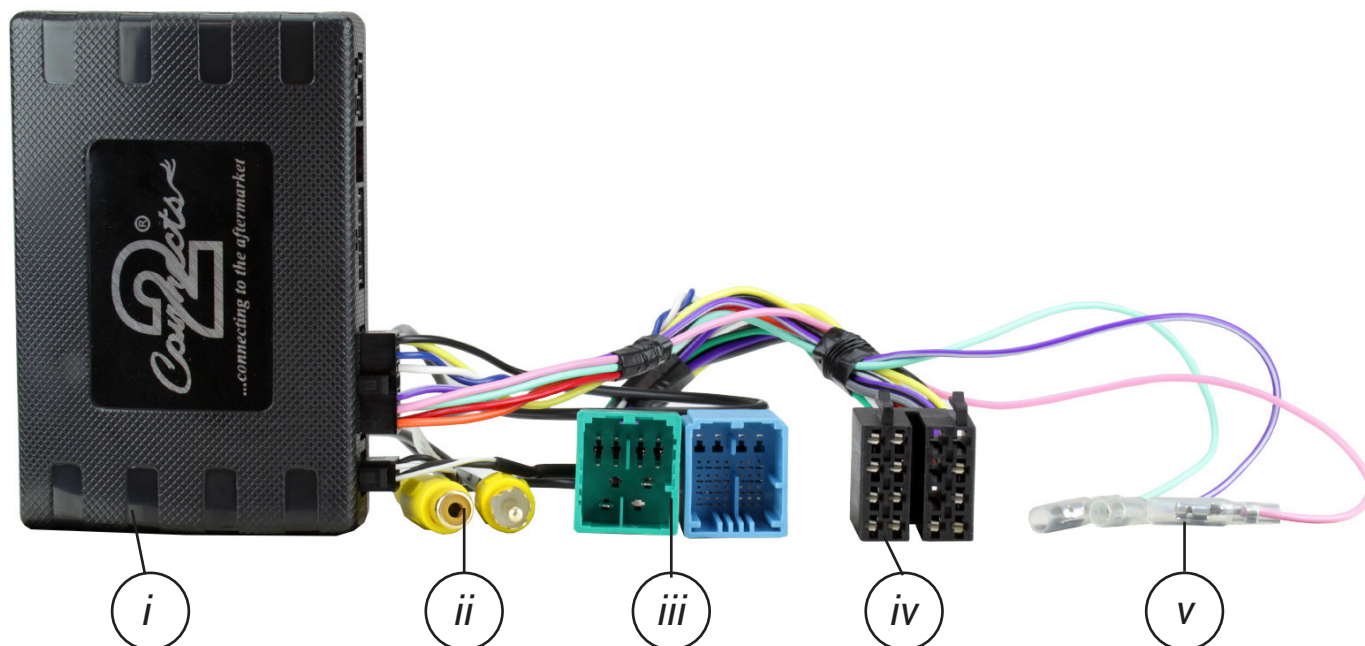

CTUFT03

## Infodapter Interface for Fiat Ducato vehicles



- i. Interface Box  
ii. Video/Camera RCA (Yellow)  
iii. 12 & 32-Way Connector

- iv. ISO Power/Speaker Connector  
v. Additional Outputs

Designed and  
Engineered  
in the UK. 

## APPLICATION

*Note: Application data is subject to change at any time*

Fiat Ducato (8 Series)

2021-UP

## FEATURES

- Retains Steering Wheel Control Functionality
- Retains Phone Button Functionality
- Retains Vehicle Settings and Generates Settings Menus
- Provides Optional Input for Aftermarket Reversing Camera
- Provides Outputs for Park Brake, Reverse Gear, Speed Pulse and Mute
- Software Updatable (*contact supplier for more information*)

### DISCLAIMER

*The information provided in this document is subject to change without notice due to manufacturer changes and/or improvements to the product/s. This instruction manual is based on documented data and research. The manufacturer of this product cannot be held responsible for any changes made to the vehicle by the manufacturer or damages that may occur through the installation of this product in accordance with the steps outlined herein.*

# PRODUCT INFORMATION

## CTUFT03

This Infodapter interface aids in the installation of an aftermarket head unit into an OEM dashboard. The interface helps to retain steering wheel control presets as well as retaining vital features and functions which include vehicle displays and safety systems (*if applicable*).

## WIRING KEY

### IN ISO CONNECTOR

Purple	Right Rear Speaker +	Yellow	Permanent 12V
Purple/Black	Right Rear Speaker -	Black	Ground
Green	Left Rear Speaker +	Red	Ignition 12V
Green/Black	Left Rear Speaker -	Orange	Illumination
Grey	Right Front Speaker +		
Grey/Black	Right Front Speaker -		
White	Left Front Speaker +		
White/Black	Left Front Speaker -		

### ADDITIONAL CONNECTIONS

Pink	Speed Pulse	Yellow RCA (Male)	Infodapter Video
Green	Park Brake	Yellow RCA (Female)	Connect Aftermarket Camera
Purple/White	Reverse Gear		

## INTERFACE CONNECTIONS

- ① Reverse Camera Extension Harness Input
- ② Power Harness Input
- ③ Head Unit Connection (Patch) Lead Input
- ④ DIP Switch 1 - 'ON' for Pioneer, 'OFF' for other brand head units  
DIP Switch 2 - 'ON' for PAL reversing camera, 'OFF' for NTSC reversing camera (Default is 'OFF'/NTSC)  
DIP Switch 3 - Change from 'OFF' to 'ON' and back to reset screen settings to factory defaults.  
Note: During this procedure, the screen background will change to red and no settings adjustments can be made.  
DIP Switch 4 - Not Used
- ⑤ Not used

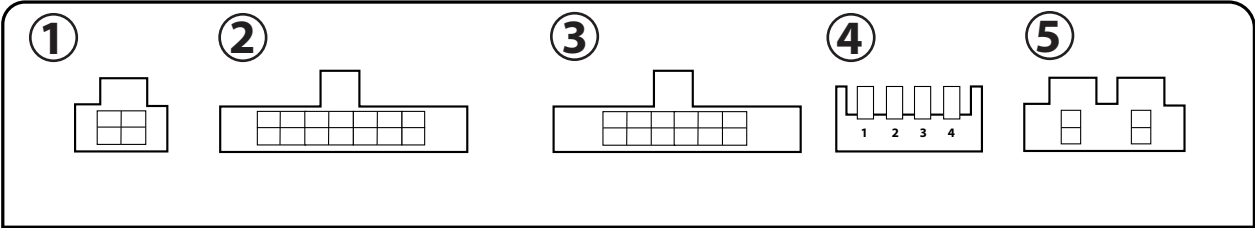

# PRIOR TO INSTALLATION

*Read the manual prior to installation. Technical knowledge is necessary for installation. The place of installation must be free of moisture and away from heat sources. Please ensure that the correct tools are used during the installation to avoid damage to the vehicle or product. Connects2 can not be held responsible for the installation of this product.*

## INSTALLATION GUIDE

See Wiring Diagram on Pg.4 for more information

*Before installing the interface, the factory stereo must be removed and disconnected. To do this, please consult the vehicle owner's manual/handbook or contact a fitting professional.*

*A stereo connection (patch) lead is also required for the installation of this interface (supplied separately). Please ensure that you have the correct lead before proceeding. For universal patch leads, prepare the wiring loops in accordance with the instruction manual supplied with the product before installation.*

1. Connect the 12 Pin connector from the stereo connection (patch) lead to the interface box
2. Connect the opposite end of the stereo connection (patch) lead to the steering wheel control input on the back of the aftermarket stereo

*NOTE: This may be a 3.5mm jack connector or a wired input depending on the brand of aftermarket stereo being fitted. Please consult the aftermarket stereo installation manual for further information on where to make the connection.*

**! IMPORTANT: THIS STEP MUST BE COMPLETED BEFORE CONNECTING POWER TO THE INTERFACE. FAILURE TO DO SO MAY RESULT IN A LACK OF FUNCTIONALITY AND THE NEED TO REINSTALL THE PRODUCT**

3. Connect the 14 Pin connector from the supplied wiring loom to the interface box.
4. Connect the power/speaker ISO connector to the power/speaker ISO connector at the rear of aftermarket stereo.

*Note: For aftermarket stereos which do not have an ISO connector, please see 'Wiring Key' on Pg.2 for information on which wires to connect. Some interfaces may also have additional 'flying' wires which can be connected to the vehicle to support various features i.e. parking brake trigger, reverse gear and speed pulse. Details of these can be found under 'Additional Connections'.*

5. Connect 4 Pin camera extension harness to the interface box.
6. Connect any additional outputs from the main wiring harness to the head unit.

*For more details surrounding the flying wires, go to Pg.2 and see 'Additional Connections'.*

7. Connect the male yellow RCA to the reverse camera input of the aftermarket head unit
8. To connect an aftermarket reversing camera, connect the female yellow RCA from the camera extension harness to the male yellow RCA of the camera (optional).

*Note: Ensure that the 'Camera Connected' option in the Preferences menu is set to 'Yes' for the camera to function correctly.*

9. Connect the 12 & 32-way connectors on the supplied harness to the relevant connectors from the vehicle.
10. Test stereo and steering wheel control functionality for correct operation before reassembling the vehicle dashboard. If steering wheel control functions are unresponsive, please uninstall the interface and wiring and reinstall carefully in accordance with the above steps.

*For further help, please contact and fill out a support ticket with the full details of your issue at:*  
**[support.connects2.com/tickets/technical](https://support.connects2.com/tickets/technical)**

# WIRING DIAGRAM

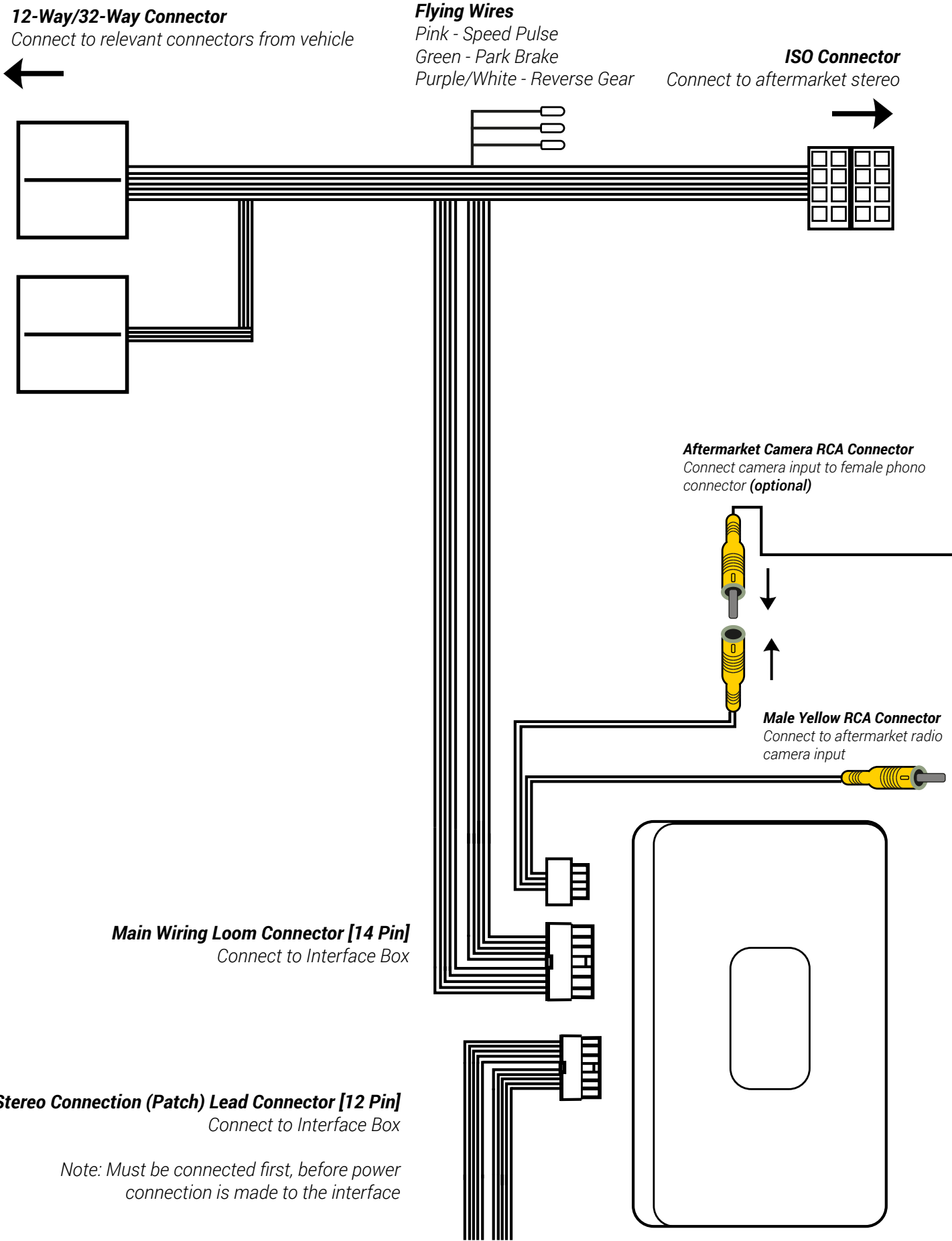

# USER GUIDE

## EXAMPLE STEERING WHEEL CONTROL DIAGRAM

The following diagram, though based on careful research, is an example only. Individual steering wheel control configurations may differ.

The Infodapter will retain several of the vehicle’s original steering wheel control functions including moving up and down between tracks, adjusting the volume and picking up or hanging up calls.

In addition to this functionality, the vehicle’s steering wheel controls are also used to enter, exit and navigate the Infodapter menus. An example configuration can be seen below:

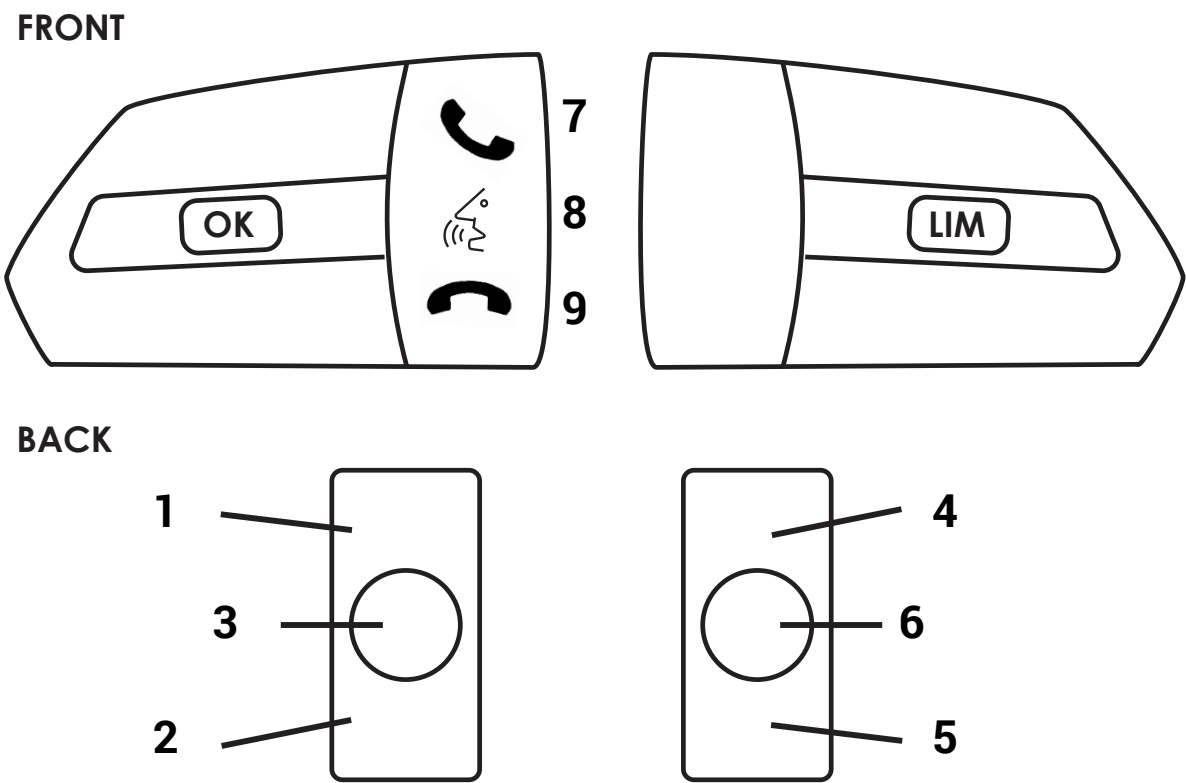

### Normal Functionality

1. Track Up
2. Track Down
3. Source \*
4. Volume Up
5. Volume Down
6. Mute
7. Pick Up
8. Speech (Long Press: *Enter Infodapter Menu*)
9. Hang Up

### Navigating the Infodapter Menus

1. Navigate options up
2. Navigate options down
8. Short Press: Select Menu Item  
Long Press: *Exit Infodapter Menu*

*Please note: steering wheel controls dealing with cruise control on the front are unaffected.*

*\*In the case that the vehicle does not feature phone buttons, the 'Source' button will act as Infodapter enter/exit button.*

# INFODAPTER MENU

Once the CTKFT03 has been installed into the vehicle successfully, simply hold the ‘Speech’ button (*Fig.8*) on the steering wheel to access the ‘Configuration Menu’.

*Note: In the case that the vehicle does not feature phone buttons, the ‘Source’ button will act as Infodapter enter/exit button.*

The Infodapters ‘Configuration menu’ showcases a series of options and settings that can be altered to tailor the users experience. To navigate these options, use the ‘Track Up’ & ‘Track Down’ buttons (*Fig.1 & 2*).

## VEHICLE SETTINGS

The Infodapter interface retains the ability to adjust vehicle settings that were present when the original head unit was installed.

The ‘Vehicle Settings’ menu contains a variety of original vehicle settings. Vehicle setup options that were available with through the original head unit will now be available through the aftermarket head unit.

*See the vehicle handbook for more information regarding these features.*

Configuration Menu
Vehicle Settings
Infodapter Settings
Language
Version
< Back

Vehicle Settings
Display >
Clock >
Doors & Locks >
Lights >
Safety & Driving Assistance >
Config Type 0
< Back

## INFODAPTER SETTINGS

The ‘Infodapter Settings’ menu contains parameters that can be selected to enhance/adapt the Infodapters layout and functionality.

## INSTALLER MENU

This menu displays a variety of options which can add/remove settings within the Infodapter menus.

Each option can be set to either ‘OFF’, ‘ON’ or ‘AUTO’ to display it, for example, if the ‘Language’ options is changed to ‘OFF’, the options will dissapear from the main Configuration Menu.

This list includes following attributes which can be controlled by the interface:

Installer Menu	
< Back	
Language	On
Version	On
Distance Units	On
Consumption Units	On
Temperature Units	On

- Language	- Version	- Distance Units	- Clock
- Temperature Units	- Consumption Units	- Speed Units	- Follow Me
- Auto Door Unlock on Exit	- Flash Lights with lock	- Courtesy Lights	- Auto Door Locks
- Daytime Running Lights	- Cornering Lights	- Ambient Lighting	- Greeting Lights
- Park Sense Volume Level	- High Beam Control	- Park Sense	- Rain Sensor
- Lane Sense Warning	- Lane Sense Strength	- Tyre Pressure Units	- Config Type
- Traffic Sign Recognition	- Traffic Sign Warning	- Vehicle Off Options	- Blindspot Assist.
- Headlight Sensor Sensitivity	- Auton./Forward Collision Warning	- Auton./Forward Collision Sensitivity	

*Note: although care has been taken to ensure the accuracy of this menu structure at the time of printing this document, sudden changes in software by the manufacturer, or incompatibilities with the interface cannot be accounted for. Do not consider this list to be exhaustive.*

# INFODAPTER MENU

## SCREEN SIZE/POSITION

Allows the user to setup the Infodapter display screen to the exact size of the aftermarket head unit being fitted.

## PICTURE SETTINGS

Allows the user to adjust the Brightness, Contrast and Saturation levels of the Infodapter menus/parking graphics.

## PREFERENCES

### • Park Assist Version

Select according to the colour configuration of the park assist fitted to the vehicle.

### • Camera Connected

Select 'Yes' if an optional camera is connected

### • Park Brake Source

Set Park Brake output to activate when park brake is on (**Brake**), when speed is less than 3km/h (**Speed**) or to remain on at all times (**Always On**)

### • Reverse Priority

Select which image (Camera or Park Assist) will be shown by default when reversing.

*(Note: this option is only available when Camera Connected is set to 'Yes')*

### • Restore Factory Settings

Select Yes to return all Infodapter settings to factory defaults

## LANGUAGE & VERSION

The latter of the settings menu gives the user a selection of languages - English/French/German/etc. - as well as the ability of viewing the current version history.

Infodapter Settings	
Screen Size & Position	
Picture Settings	
Preferences	
Installer Menu	
< Back	

Infodapter Settings	
Park Assist Version	0
Camera Connected	Yes
Park Brake Source	Speed
Reverse Priority	Park Assist
Restore factory settings	>
< Back	

Language	
●English	⦿Deutsch
⦿Nederlands	⦿Italiano
⦿Français	⦿Español
⦿Swedish	⦿Brasileiro
⦿Greek	⦿Hungarian
⦿Polski	⦿Português
⦿Russian	⦿Türkçe

# NOTES

---