



INSTALLATION INSTRUCTIONS FOR PART 95-7416G

APPLICATIONS

Nissan Maxima (w/ Bose and/or comfort and convenience packages) 2000-2003

95-7416G

KIT FEATURES

- DDIN Head Unit Provision
- Painted scratch resistant gray to match factory dash



KIT COMPONENTS

- A) Double DIN Trim Plate

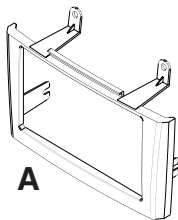

WIRING AND ANTENNA CONNECTIONS (Sold Separately)

Harness:

- 70-7550 - Nissan harness 95-up
- 70-7551 - Nissan amp interface harness 95-up

Antenna Adapter:

- 40-NI10 - Nissan antenna adapter 1987-2008

TOOLS REQUIRED:

- Socket Wrench • Panel Removal Tool • Phillips Screwdriver



METRA. THE WORLD'S BEST KITS.™



1-800-221-0932



www.metraonline.com

© COPYRIGHT 2007-2009

METRA ELECTRONICS CORPORATION

TABLE OF CONTENTS

Dash Disassembly

- Nissan Maxima 2000-2003.....1

Kit Assembly

- DDIN Head Unit Provision2

***Note:**

Refer also to the instructions included with the aftermarket radio.



KNOWLEDGE IS POWER

Enhance your installation and fabrication skills by enrolling in the most recognized and respected mobile electronics school in our industry. Log onto www.installerinstitute.com or call 800-354-6782 for more information and take steps toward a better tomorrow.



Metra recommends MECP certified technicians.

NISSAN MAXIMA 2000-2003

- 1** Disconnect the negative battery terminal to prevent an accidental short circuit.
- 2** Unclip and remove the climate control vent panel. (Figure A)
- 3** Remove (2) Phillips screws expose behind a/c vents. (Figure A)
- 4** Remove the ashtray and (1) Phillips screw exposed in the ashtray cavity. (Figure B)
- 5** Unclip and remove the gear shift trim panel. (Figure B)
- 6** Remove (2) Phillips screws exposed behind gear shift trim panel. (Figure B)
- 7** Unclip and remove the radio/climate control bracket assembly.
- 8** Remove (8) Phillips screws securing the factory radio to the bracket assembly.

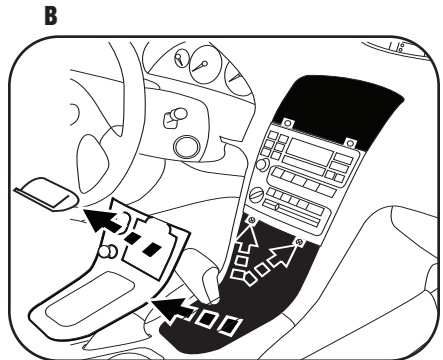
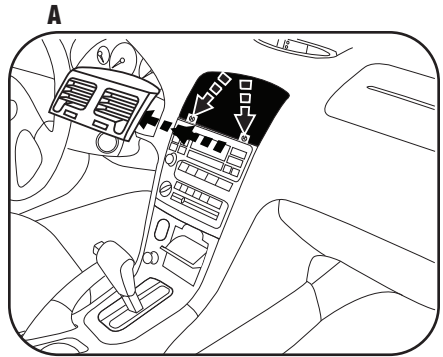

Continue to kit assembly.

DOUBLE DIN HEAD UNIT PROVISION

****Note: Refer also to the instructions included with the aftermarket radio.***

- 1** Locate the factory wiring harness in the dash. Metra recommends using the proper mating adapter from Metra or AXXESS. Re-connect the negative battery terminal and test the unit for proper operation.
- 2** Place the 7416 DDIN trim plate over the aftermarket radio and screw the factory climate/ bracket assembly together using the ISO screws supplied with the aftermarket radio. (Figure A)
- 3** Mount the radio/climate/ bracket assembly into the dash using the four factory screws removed in disassembly. (Figure B)
- 4** Reassemble dash in reverse order of disassembly.

A

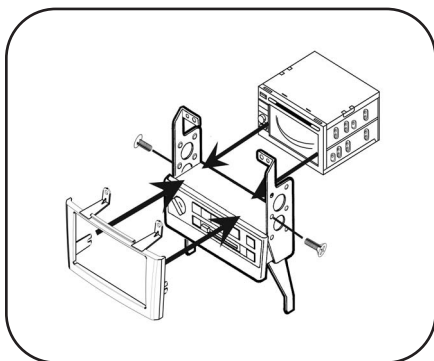

B

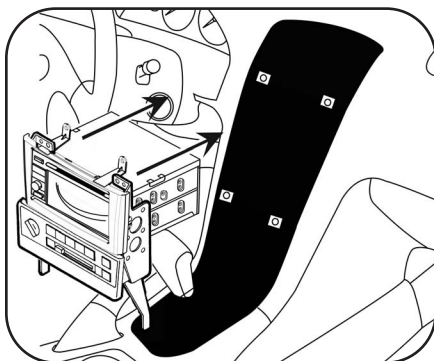

95-7416G INSTRUCTIONS

METRA. THE WORLD'S BEST KITS.™



1-800-221-0932



www.metraonline.com

REV. 12/07/09 © COPYRIGHT 2003-2009 METRA ELECTRONICS CORPORATION INST95-7416G