



7" TFT DIGITAL LCD Monitor

for MXN-HD7DM - Owner's Manual

· I · N · D · E · X ·

PACKAGE CONTENTS	03
OPERATION	04
SYSTEM SETTING	05
FUNCTION	05
PICTURE	06
CAMERA SET UP	06
NORMAL/MIRROR	07
AUTO PICTURE SCAN	07
CAMERA TRIGGER	08
AUDIO	09
TRIGGER AUDIO	09
DISTANCE MARKER ADJUST	10
SCAN ON/OFF FUNCTION	11
LOCK ON/OFF FUNCTION	11
INSTALLATION	12
MONITOR INSTALLATION WITH STAND BRACKET & SUNVISOR	12
INSTALLATION OF HEAVY DUTY MOUNTING BRACKETS	13
CONNECTION	14
CAMERA INPUT	14
SPECIFICATION	15





PACKAGE CONTENTS

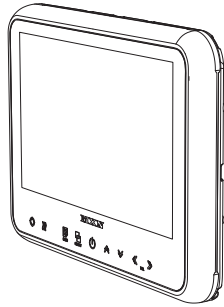

MONITOR

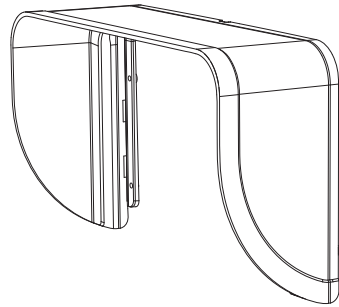

SUNVISOR



SUNVISOR SCREWS



CABLE CLIP



BRACKET SCREWS



STAND BRACKET



MANUAL

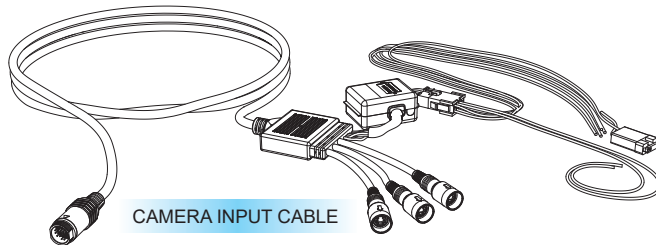

CAMERA INPUT CABLE

ITEM	Q'TY
MONITOR	1
SUNVISOR	1
SUNVISOR SCREW	4
STAND BRACKET	1
BRACKET SCREW	3
CABLE CLIP	2
CAMERA INPUT CABLE	1
MANUAL	1



OPERATION

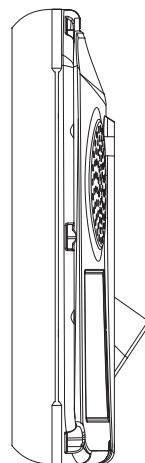
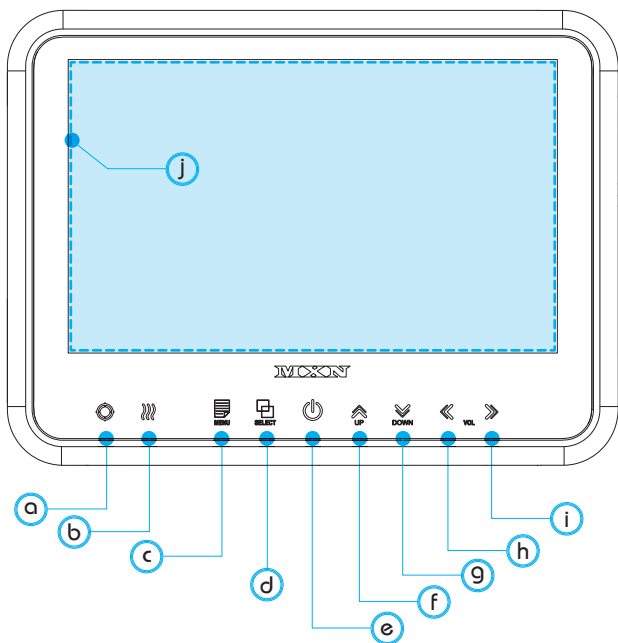

A. DAY/NIGHT SENSOR (CDS)

Automatic brightness control sensor.

B. HEATER LAMP

Orange color will be illuminated in case heater function is activated.

C. MENU

Press [MENU] button for system setting.

D. SELECT

Press [SELECT] button to select the respective camera channel. (CAM1-CAM2-CAM3-CAM1..)

E. POWER

Press [POWER] button to turn on/off the monitor.

F. UP

Press [UP/DOWN] button to navigate the menu for system setting.

G. DOWN

Press [UP/DOWN] button to navigate the menu for system setting.

H. LEFT

Press [LEFT/RIGHT] button to adjust monitor volume. Use [LEFT/RIGHT] button to change OSD setting during system setting.

I. RIGHT

Use [LEFT/RIGHT] button to change OSD setting during system setting.

J. VIEW AREA



SYSTEM SETTING

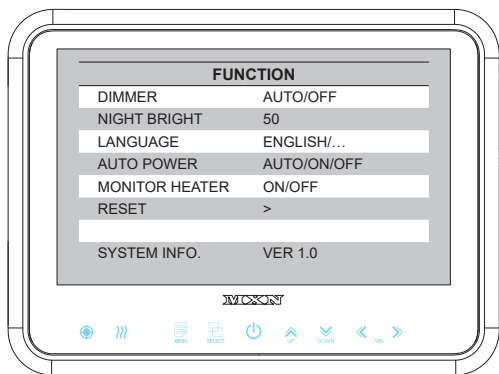

RESET

Press > button to go the factory default setting.

SYSTEM INFO.

Refers to system information of the monitor.

FUNCTION

DIMMER (Automatic Brightness Control)

Select **AUTO** or **OFF** to have Automatic or Manual brightness of the monitor.



REMARK: By activating **DIMMER AUTO** function, the monitor adjusts the brightness according to the environment.

NIGHT BRIGHT (Brightness during night conditions)

Select the DIMMER to 「**AUTO**」 and adjust the value of the backlight into the required setting. During night conditions the backlight will automatically perform brightness according to this setting.

LANGUAGE

Provide 6 Multi-lingual OSD [ENGLISH, SWEDISH, DANISH, NORWEGIAN, DUTCH, FINNISH].

Select the preferred **LANGUAGE**.

AUTO POWER

Select monitor activation function as below.

[AUTO] Monitor keeps the last setting in memory.

[ON] Monitor starts up 「**Power-ON**」 mode automatically.

[OFF] Monitor starts up 「**Stand-By**」 mode automatically.

MONITOR HEATER

Select **MONITOR HEATER 「ON」** to have automatic heating function in order to enable fast picture start during extreme cold weather condition.



Remark: During **MONITOR HEATER ON** mode, Heating activates automatically when the temperature of inside monitor is below 0 degree Celcius.
When the temperature of inside monitor is over 0 degree Celcius, heating stops automatically.



SYSTEM SETTING

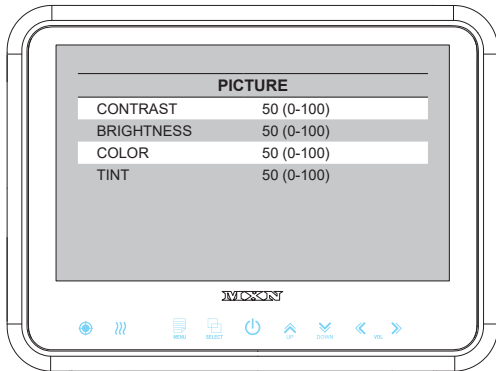

PICTURE

Press [LEFT/RIGHT] button to adjust preferred **PICTURE** of the monitor.

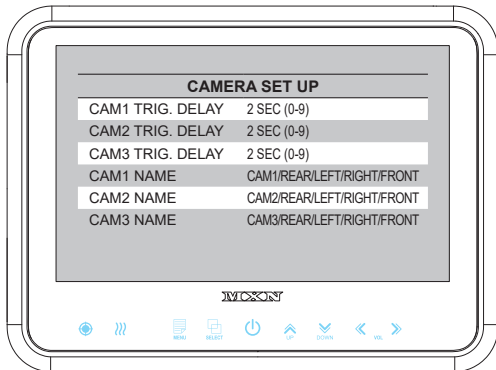

CAMERA SET UP

TRIG. DELAY

When a **TRIGGER** wire is connected to a pulse DC power signal (e.g. direction indicator lights) then the [TRIGGER DELAY] function avoids repeating **ON/OFF** of the monitor.

CAMERA NAME

CAMERA NAME can be selected as **CAM1, 2, 3/REAR/LEFT/RIGHT/FRONT**.

7" TFT DIGITAL LCD

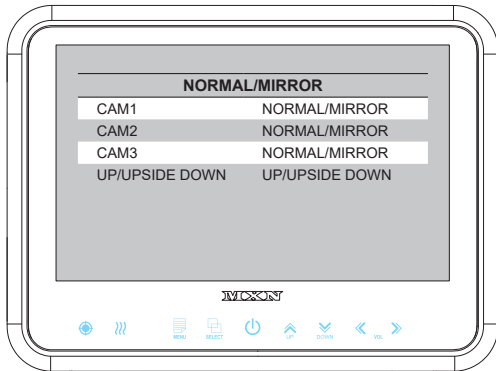

NORMAL/MIRROR

NORMAL/MIRROR

Each camera picture (CAM1/CAM2/CAM3) can be switchable as **NORMAL/MIRROR** image.

UP/DOWN

Camera pictures can be switchable as **UP/DOWN** image.

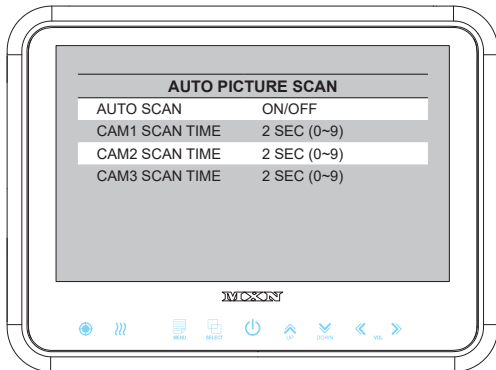

AUTO PICTURE SCAN

Each scanning time of CAM1/CAM2/CAM3 can be selected.

REMARK: If the **SCAN TIME** is set as 「0」, monitor skips its channel during the scanning.

Press [**UP**] button for 4 seconds to **ACTIVATE/INACTIVATE** auto scanning function.



SYSTEM SETTING

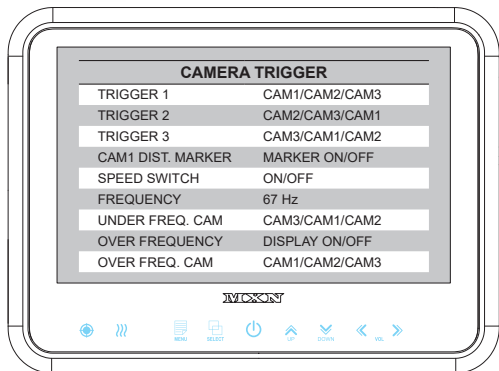

CAMERA TRIGGER

TRIGGER 1/2/3 (Trigger source selection)

Select the required trigger source at CAM1/CAM2/CAM3.



REMARK

TRIGGER PRIORITY: TRIGGER 1 > TRIGGER 2 > TRIGGER 3

CAM1 DIST. MARKER

Select **ON** to have distance marker (parking line) for **CAM1**.

Distance marker is displayed as soon as **TRIGGER 1** signal is activated.

SPEED SWITCH

The orange wire needs to be connected with the vehicle's tachometer signal and via **MENU** the **SPEED SWITCH** needs to be selected **ON**.

At **FREQUENCY** 67Hz setting (and most common used tachometer signal) the selected camera will be displayed during a speed of 0~33km/h. Select the concerning camera via 『**UNDER FREQUENCY CH:**』 (At different type tachometer signals the **FREQUENCY** needs to be adjusted into higher or lower value than this example)

Over 33km/h (72Hz) the selected camera will be switched **OFF** automatically. When the speed slows down, then the selected camera will be switched **ON** automatically again at 30km/h. Instead of automatic switch **OFF** at a speed over 33km/h it is also possible to activate another video source, such as a navigation picture from an optional navigation computer. In this case user needs to select 『**OVER FREQUENCY DISPLAY: ON**』 and user needs to select 『**OVER FREQUENCY CH:**』

In case of **TRIGGER** activation during 『**SPEED SWITCH ON**』 mode, then **TRIGGERS** 1~3 will overrule 『**SPEED SWITCH**』 function.

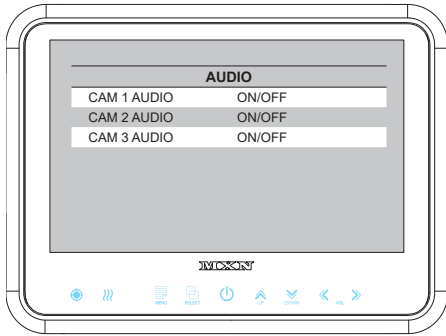

AUDIO

Audio **MUTE** Mode in normal mode.

When the mode is [**ON**], audio will be on (activated)

When the mode is [**OFF**], audio will be off (mute).

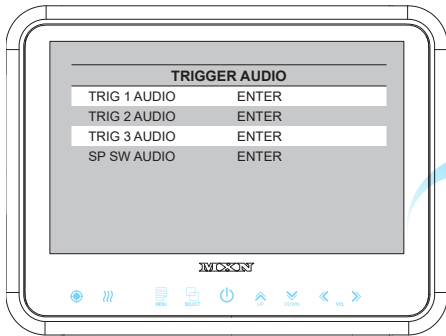

TRIGGER AUDIO

Audio **MUTE** Mode in Trigger mode.

Choose the trigger and then push [**ENTER**].

The Audio setting menu will be shown as below.

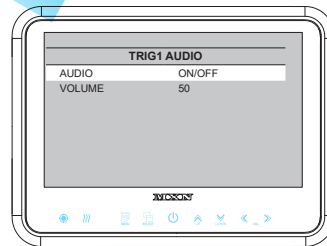

When the mode is [**ON**], audio will be on (activated).

When the mode is [**OFF**], audio will be off (mute).

The user may adjust the volume.



SYSTEM SETTING

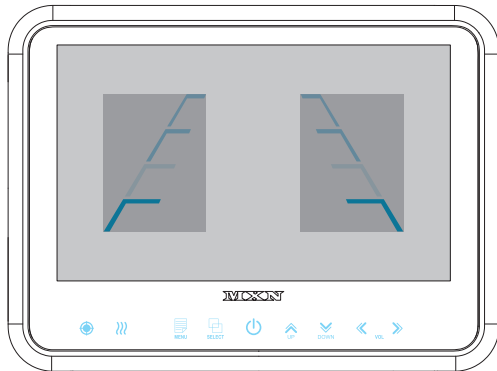

DISTANCE MARKER ADJUST

User can adjust location of distance marker.

At Power **ON** mode, select distance marker by pressing [**UP/DOWN**] buttons.

When color of distance markers is seen as **RED** color, user can adjust the lines **UP/DOWN** or **LEFT/RIGHT**.

When both color of distance markers are seen as **RED** color, both lines can be adjusted **LEFT/RIGHT**.

When left color of distance marker is seen as **RED** color, left line of distance marker can be adjusted **LEFT/RIGHT**.

When right color of distance marker is seen as **RED** color, right line of distance marker can be adjusted **LEFT/RIGHT**.

7" TFT DIGITAL LCD

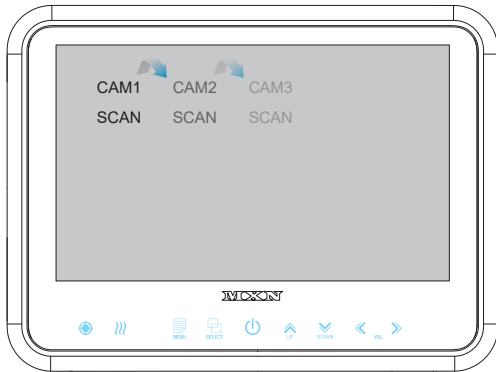

SCAN ON/OFF FUNCTION

At **Power-ON** mode, hold **[UP]** buttons pressed for 4 seconds to activate Auto Scan Picture function.

During the auto scanning mode, press **[UP]** button for 4 seconds to inactivate Auto Scan Picture function.

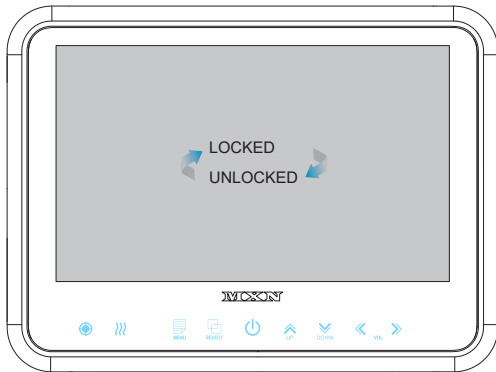

LOCK ON/OFF FUNCTION

LOCK ON/OFF FUNCTION

The set up menu can be locked as prevention against unauthorized users.

LOCK ON mode

At **Power-ON** mode, hold **[DOWN]** button pressed for 10 seconds to set up **LOCK ON** function.

When **[LOCKED]** is displayed on the screen, user can use **[POWER, SELECT, VOLUME]** buttons only and use can do setting for **PICTURE** menu.

LOCK OFF mode

At **Power-ON** mode, hold **[DOWN]** button pressed for 10 seconds to set up **LOCK OFF** function.

When **[UNLOCKED]** is displayed on the screen, user can use all functions of the set up menu.

INSTALLATION

MONITOR INSTALLATION WITH STAND BRACKET & SUNVISOR

- A** Remove a protection tape and attach **STAND BRACKET** into stand place, then fix it with the supplied screws.
- B** Connect **STAND BRACKET** with monitor and adjust height/angle.
- C** Attach **SUNVISOR** to the **MONITOR** and fix it with the supplied screws.
- D** Connect **CAMERA INPUT CABLE** to the **MONITOR**.

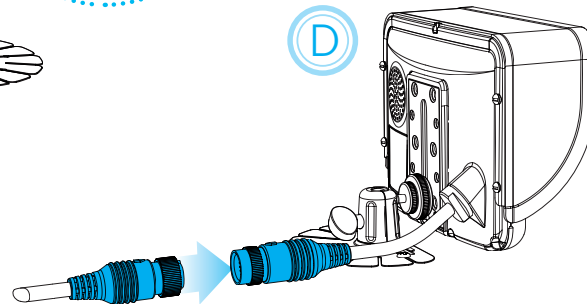
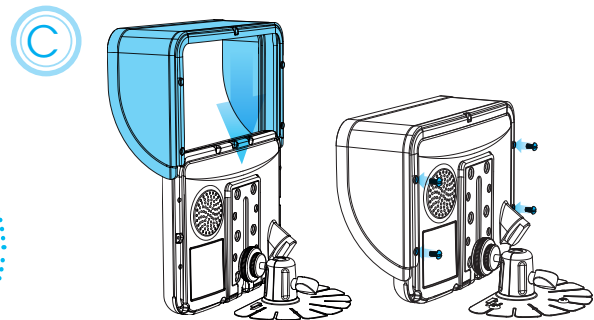
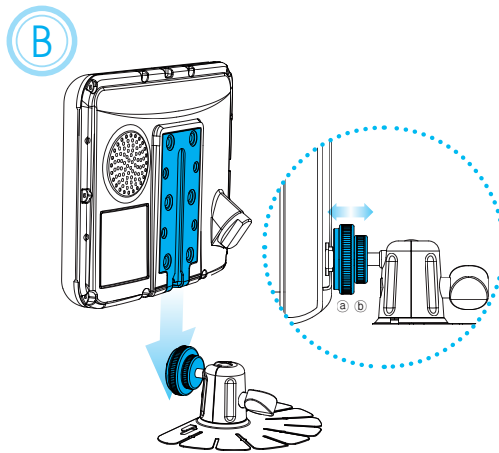
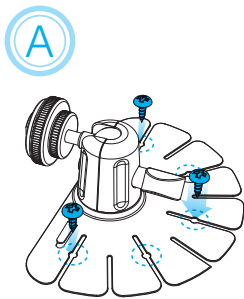

7" TFT DIGITAL LCD

INSTALLATION OF HEAVY DUTY MOUNTING BRACKETS

MONITOR can be connected with different type of heavy duty mounting brackets.
Please check the compatibility in advance, then please follow installation as described below.

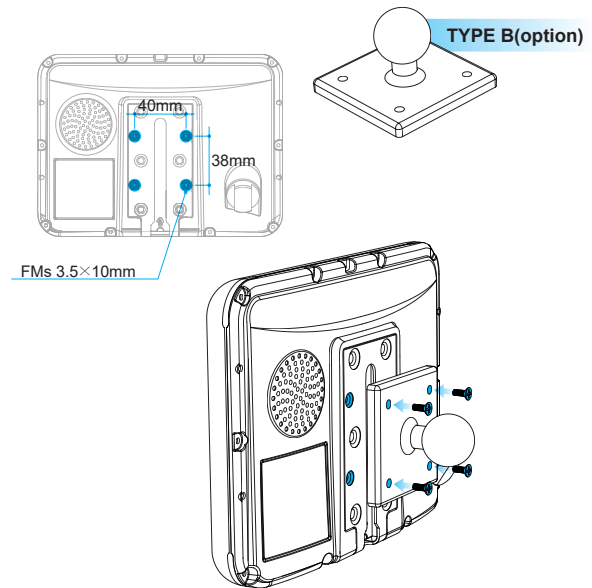
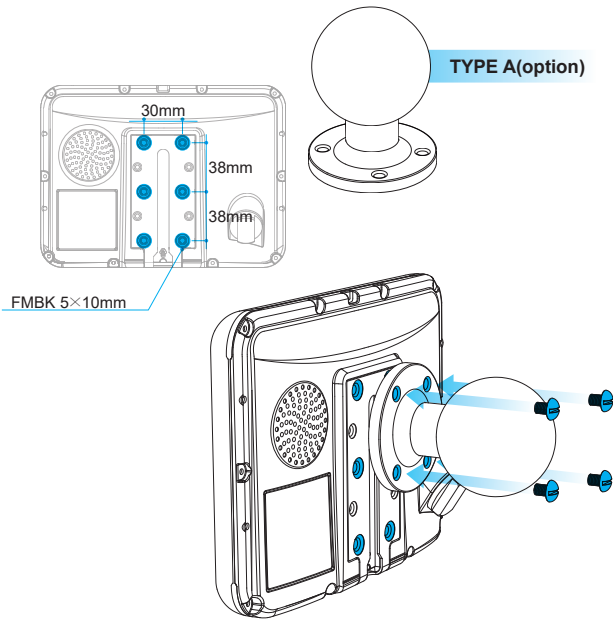



CONNECTION

7" TFT DIGITAL LCD Monitor

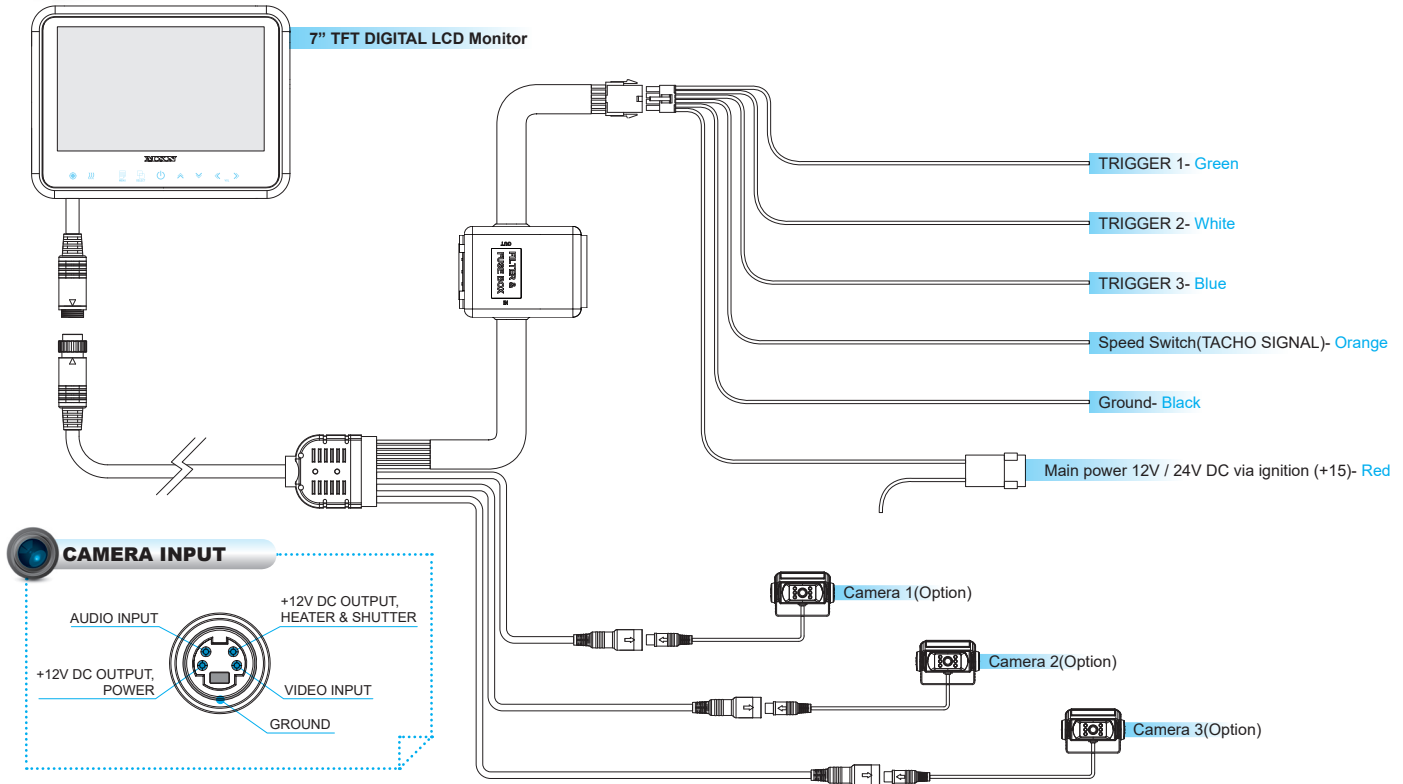



SPECIFICATION

7" TFT DIGITAL LCD



ITEM	SPECIFICATION
LCD Screen Size	7" Wide Diagonal
Dimensions	190(W) × 142(H) × 42.85(D)mm
Display dimensions	152.4 × 91.44mm
Power Input	DC 12 to 30 Volt Free Input
Power Consumption	12 Watt Max.
Video System	NTSC / PAL / SECAM Auto Detection
Sync. System	Internal
Brightness	500 cd/m ²
Display Resolution	800 × 480 pixel
Viewing Angle	Top: 50. Bottom: 60. Left: 65. Right: 65.
Color Configuration	RGB Stripe
Dimmer	Automatic / Manual
Speaker Impedance	8 ohm, 0.3 Watt Max.
Operating Temp.	-25°C ~ +75°C
Storage Temp.	-30°C to + 85°C
Impact Rating	4G
Camera Connector	4-pin mini DIN (MXN configuration)
Housing	Soft black(Al12)
ON-Screen Display Control Functions	Volume · Brightness · Color · Contrast · Tint · CAM Screen 1/2/3 · CAM Trigger 1/2/3 · Heater · Speedswitch · Auto Power · Distance marker · Auto Picture Scan · Dimmer · Language · Direction · Reset.
Supplied Accessory	Die-Cast Mounting Bracket / 1 pce, Screw Kit / 1set, Manual, Sun Shield / 1 pce, Power cable / 1 set
Weight	790g



7" TFT DIGITAL LCD Monitor

for MXN-HD7DM - Owner's Manual

MXN®